

## 15696C Pressure Regulating Valves

15696C	50 to 850 Lbs.,	Variation	26 to 60 GPM
15696C1	800 to 1600 Lbs.,	Variation	10 to 60 GPM
15696C2	100 to 1200 Lbs.,	Variation	10 to 60 GPM
15696C5	800 to 2000 Lbs.,	Variation	10 to 70 GPM

### INSTALLATION & OPERATION

**WARNING: THE BY-PASS OPENING AT THE BOTTOM OF THE VALVE MUST NOT HAVE A VALVE OR ANY OTHER OBSTRUCTION IN IT.**

The set screw on the top of the valve increases the pressure setting as it is tightened and decreases the pressure setting as it is loosened. Initial pressure setting should be made by following these steps.

1. Loosen adjusting set screw to release spring tension.
2. Start and run pump at desired operating speed with discharge open.
3. Close discharge.
4. Regulate pressure by tightening adjusting screw.
5. Open discharge and readjust to correct the pressure drop.

If a slight readjustment does not correct the pressure drop, the discharge capacity is probably more than the pump is producing.

**NOTE: VERTICAL INSTALLATION WILL INSURE PROPER OPERATION**

**WARNING: RUNNING THE ADJUSTMENT SCREW ALL THE WAY DOWN WILL LOCK THE OVERFLOW VALVE CLOSED.**

### SERVING PRESSURE REGULATING VALVES

**REPLACING PLUNGER CUP AND/OR VALVE** — First loosen the adjustment screw to release all spring pressure. Then remove the four cap screws on top of the upper head and remove the spring tube assembly. The springs and components parts may be lifted off and set aside. The plunger assembly can then be pulled out of the cylinder. The valve is unscrewed from the plunger rod by loosening the set screw and inserting a punch or similar tool in the hole opposite the set screw. The valve, plunger cup, and "O" ring should be replaced as needed and the regulator reassembled, carefully installing the parts in proper order and place. A little lubricating oil on the lips of the plunger cup will aid in reassembly. The spring tube must be drawn down tight. Drawing the four cap screws down evenly prevents leakage around the gasket under the cylinder. Adjust pressure setting.

**REPLACING CYLINDER** — The spring tube and plunger assembly should be removed as instructed. The cylinder can then be worked loose and removed with a screw driver. The old gasket under the cylinder should be removed and the gasket area cleaned. Install a new gasket, replace the cylinder and plunger assembly and remaining parts. Adjust pressure setting.

**REPLACING VALVE SEAT** — The spring tube and plunger assembly should be removed as instructed. The overflow line must then be removed. The valve seat can now be removed with a blunt punch and a hammer. Drive upward on the bottom of the valve seat. The contact area for the valve should be cleaned before the new valve seat is put into place. Tap the new seat into position with a block of wood or brass bar being careful not to damage the valve seat face. Reassemble as instructed. Adjust pressure setting.

**LUBRICATION** — An occasional squirt of oil around the adjusting screw and around the plunger cap will improve the performance and prolong the life of the valve. The plunger cup is oiled through the holes in the side of the upper head of the regulator.

# 15696C, 15696C1, 15696C2 & 15696C5 Pressure Regulating Valves Parts List

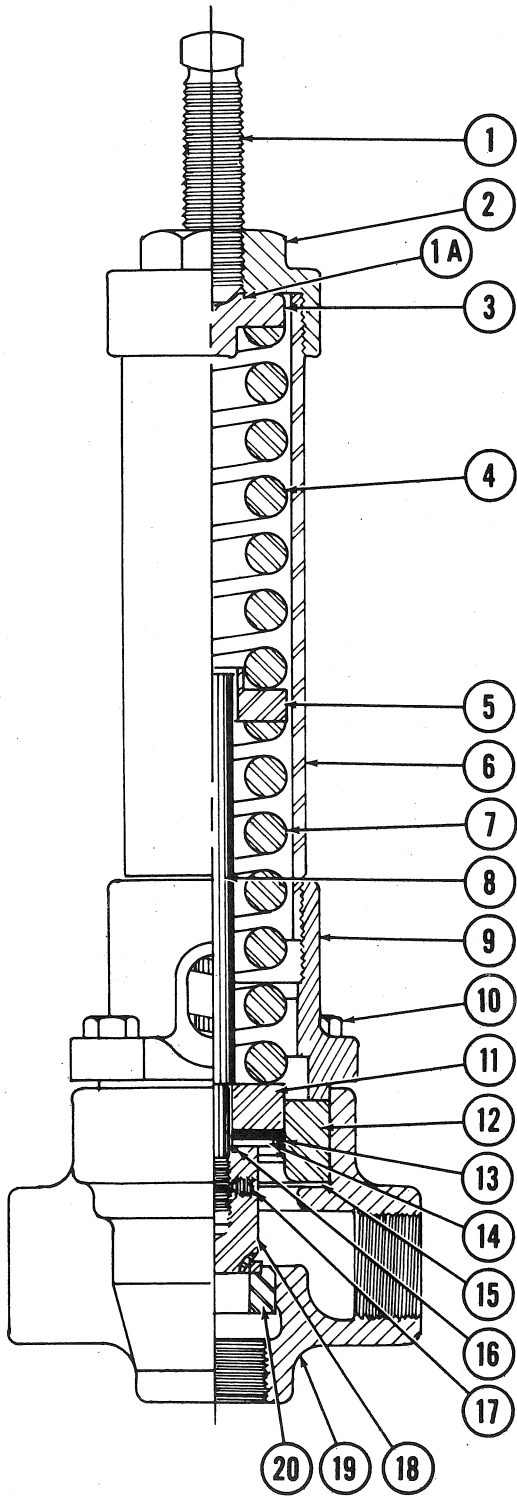

No. 15696C1, 15696C5  
Pressure Regulator

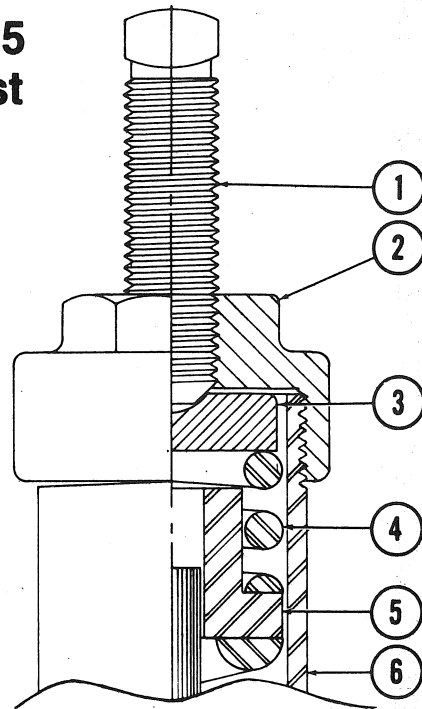

No. 15696C, 15696C2  
Pressure Regulator  
(Balance of parts not shown same  
construction as No. 15696C1)

PARTS LIST

Catalog Number of Regulator		15696C	15696C1	15696C2	15696C5
P.S.I		50-850	800-1600	100-1200	800-2000
G.P.M.		26-60	10-60	10-60	10-70
Ref. No.	Name of Part	No. Reg.	Part Number	Part Number	Part Number
1	Set Screw, Adjusting	1	6368A13	6368A13	6368A13
1A	Ball; On 15696C5 Only	1			5373A12
2	Cap, Spring Tube	1	4603A1	4603A1	4603A1
3	Plate, Spring	1	15697A030	4606A1	15697A030
4	Spring, Upper	1	15698A	M1568A	15698A
5	Guide, Spring	1	15699A	15699A1	15699A
6	Tube, Spring	1	M1545A2	M1545A3	M1545A2
7	Spring, Lower	1	M1568A	M1568A	M1568A
8	Rod, Plunger	1	15701A	15701A	15701A
9	Head, Upper	1	4605B1	4605B1	4605B1
10	Cap, Screw, 1/2" X 1/2"	4	19103A9	19103A9	19103A9
	Lockwasher	4	5454A4	5454A4	5454A4
11	Follower, Plunger	1	15702A	15702A1	15702A1
12	Cylinder	1	15703A000	15703A001	15703A001
13	Plunger Cup	1	5504A24	13046A14	13046A014
14	Washer, Or Expander	1	5030A115	21209A	21209A
14A	"O" Ring	1		5876A29	5876A29
15	Gasket, Asbestos	1	5059A368	5059A368	5059A368
16	"O" Ring, 1/2" I.D. 1 1/16" O.D., 3/32" dia.	1	5876A5	5876A5	5876A5
17	Set Screw, Headless, S.S. 5/16" x 3/8" long, Nylock	1	13321A2	13321A2	13321A2
18	Valve	1	15704A	15704A	15704A
19	Body with valve seat	1	15746C4	15746C4	15746C4
20	Valve seat for body	1	15747A	15747A	15747A